

# Pro-Line Aluminum Series™

## One-Sided 45° Offset Ladder Pull Handle

Concealed Surface Mounts  
Suitable for Wood and Metal Doors

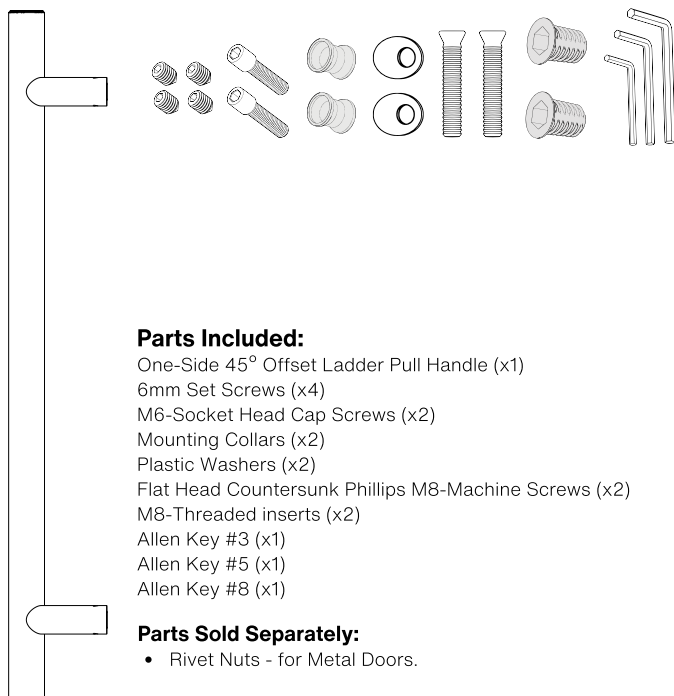

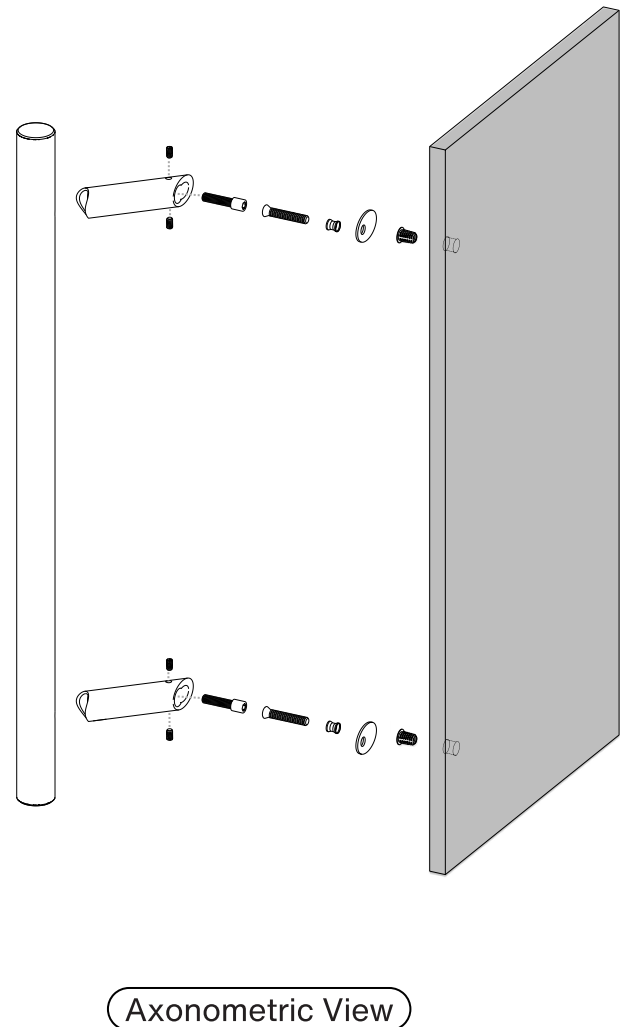
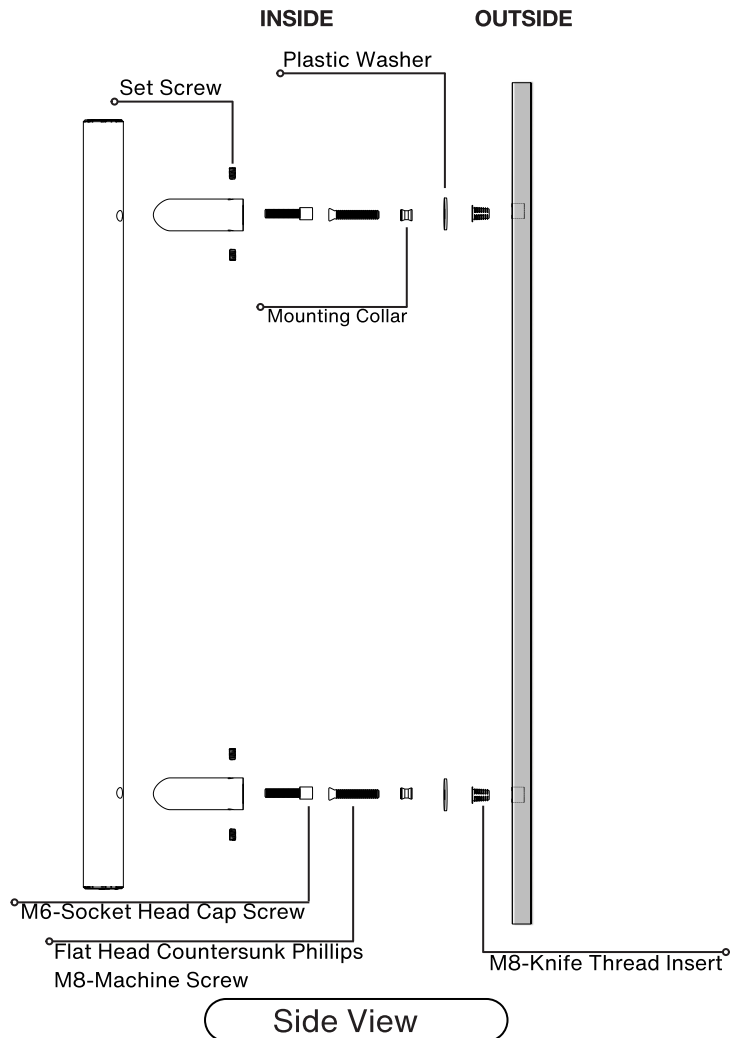
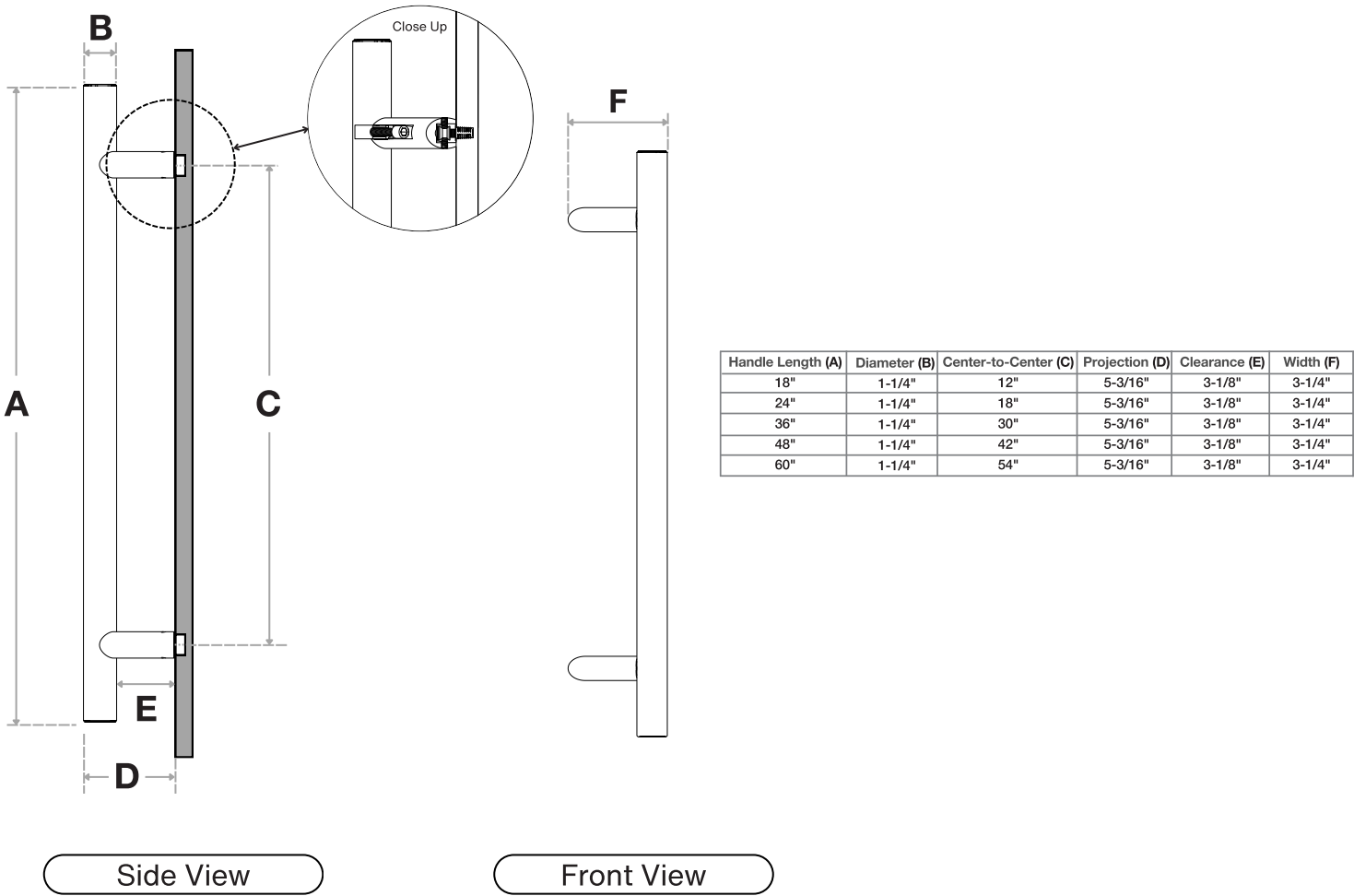

FINISHES (1)

- Clear Anodized Aluminum = C
- Black Anodized Aluminum = B

OVERALL LENGTHS (2)

- 18" = 18
- 24" = 24
- 36" = 36
- 48" = 48
- 60" = 60

DIAMETERS (3)

1-1/4" = 1250

For a complete **SKU#** add Finish **(1)**, Overall length **(2)** and Diameter **(3)**

SH-PRO-ALU-OLP-CO-

FINISH

-

OVERALL LENGTH

-

DIAMETER

Material: Aluminum.

DOOR TYPE

WOOD & METAL DOORS.  
UP TO 4-3/4"

HOLE SIZE  
DIAMETER

7/16"

Not all Finishes, Lengths and Diameters are available in this style.  
For customization requests, please contact us at [info@strongarhardware.com](mailto:info@strongarhardware.com)

# Pro-Line Aluminum Series™

**One-Sided 45° Offset Ladder Pull Handle**  
Decorative Thru-Bolt End Caps  
Suitable for Glass, Wood, and Metal Doors

INSIDE

OUTSIDE

Plastic Washer

M8-Full Threaded Mounting Screw

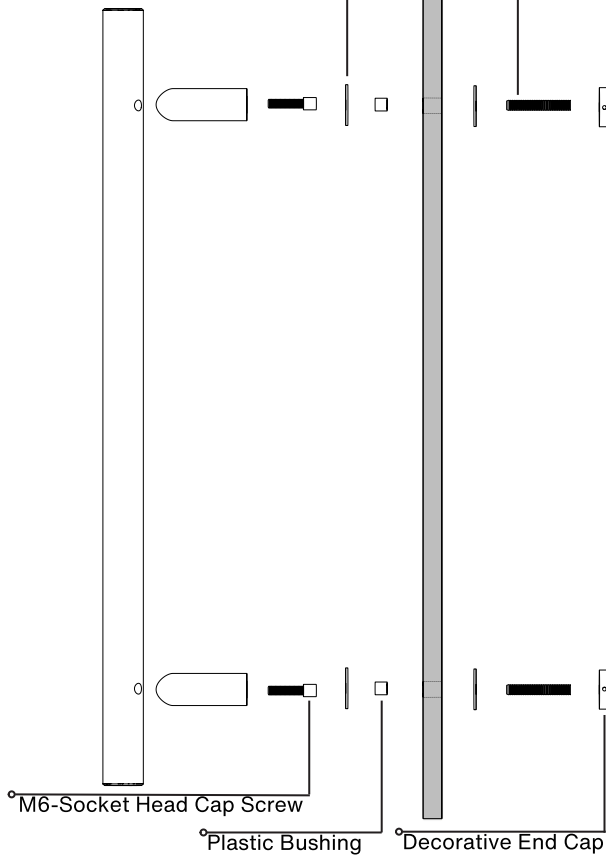

Side View

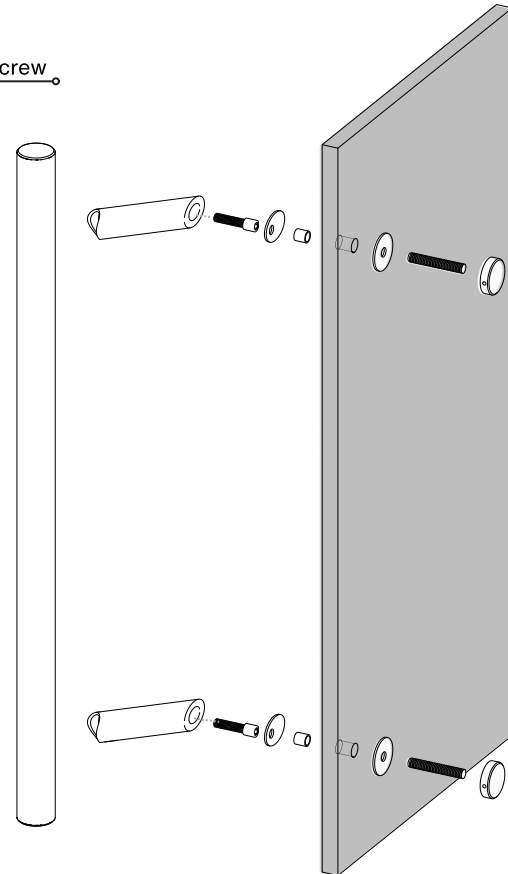

Axonometric View

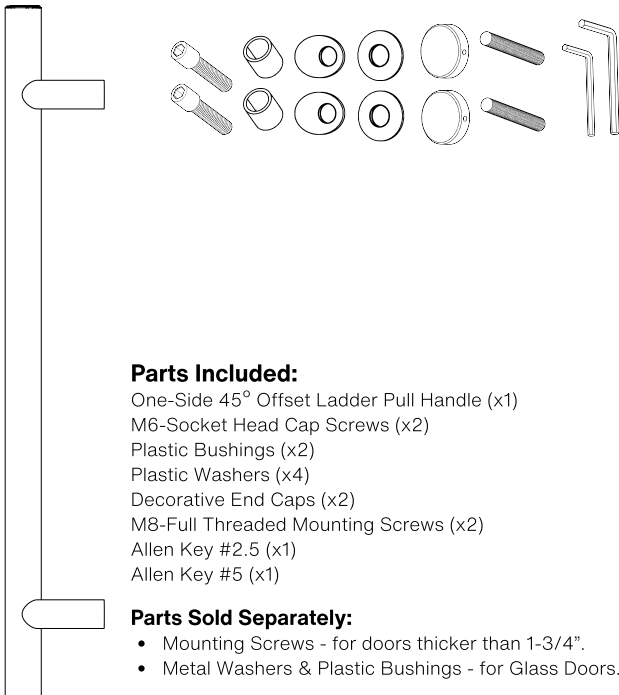

## Parts Included:

- One-Side 45° Offset Ladder Pull Handle (x1)
- M6-Socket Head Cap Screws (x2)
- Plastic Bushings (x2)
- Plastic Washers (x4)
- Decorative End Caps (x2)
- M8-Full Threaded Mounting Screws (x2)
- Allen Key #2.5 (x1)
- Allen Key #5 (x1)

## Parts Sold Separately:

- Mounting Screws - for doors thicker than 1-3/4".
- Metal Washers & Plastic Bushings - for Glass Doors.



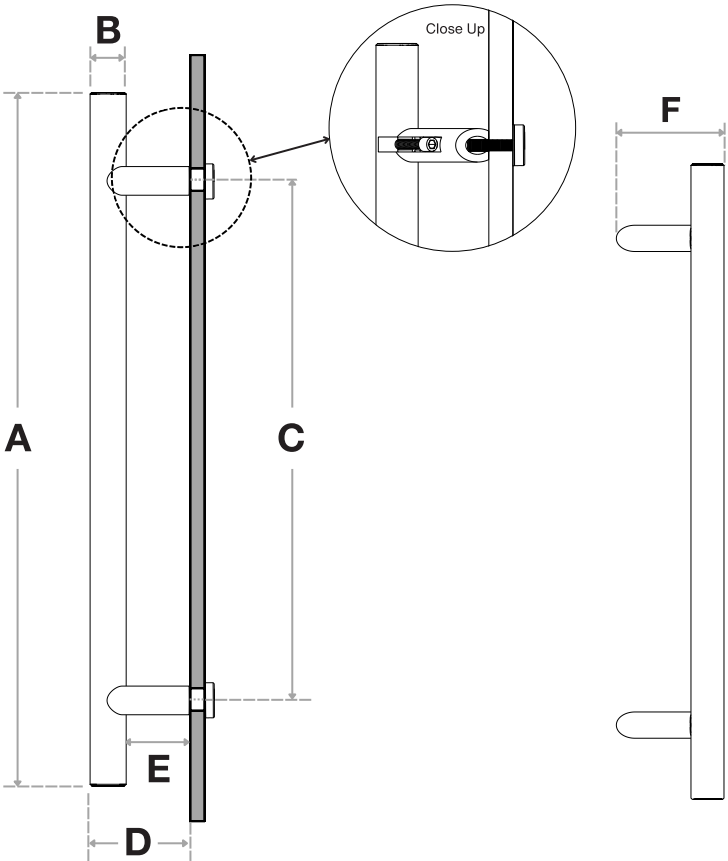



Handle Length (A)	Diameter (B)	Center-to-Center (C)	Projection (D)	Clearance (E)	Width (F)
18"	1-1/4"	12"	5-3/16"	3-1/8"	3-1/4"
24"	1-1/4"	18"	5-3/16"	3-1/8"	3-1/4"
36"	1-1/4"	30"	5-3/16"	3-1/8"	3-1/4"
48"	1-1/4"	42"	5-3/16"	3-1/8"	3-1/4"
60"	1-1/4"	54"	5-3/16"	3-1/8"	3-1/4"

Side View

Front View

FINISHES (1)

-  Clear Anodized Aluminum = C
-  Black Anodized Aluminum = B

OVERALL LENGTHS (2)

- 18" = 18
- 24" = 24
- 36" = 36
- 48" = 48
- 60" = 60

DIAMETERS (3)

1-1/4" = 1250

For a complete **SKU#** add Finish **(1)**, Overall length **(2)** and Diameter **(3)**

SH-PRO-ALU-OLP-DE-

FINISH

-

OVERALL LENGTH

-

DIAMETER

Material: Aluminum.

DOOR TYPE	GLASS DOORS UP TO 3/4"	WOOD & METAL DOORS. UP TO 4-3/4"
HOLE SIZE DIAMETER	5/8"	5/16"

Not all Finishes, Lengths and Diameters are available in this style.  
For customization requests, please contact us at [info@strongarhardware.com](mailto:info@strongarhardware.com)

# Pro-Line Aluminum Series™

**One-Sided 45° Offset Ladder Pull Handle**  
 Countersunk Thru-Bolt Washers  
 Suitable for Glass, Wood and Metal Doors

INSIDE

OUTSIDE

Plastic Washer

Countersunk Washer

Plastic Bushing

M6-Socket Head Cap Screw

M8-Socket Flat Head Mounting Screw

Side View

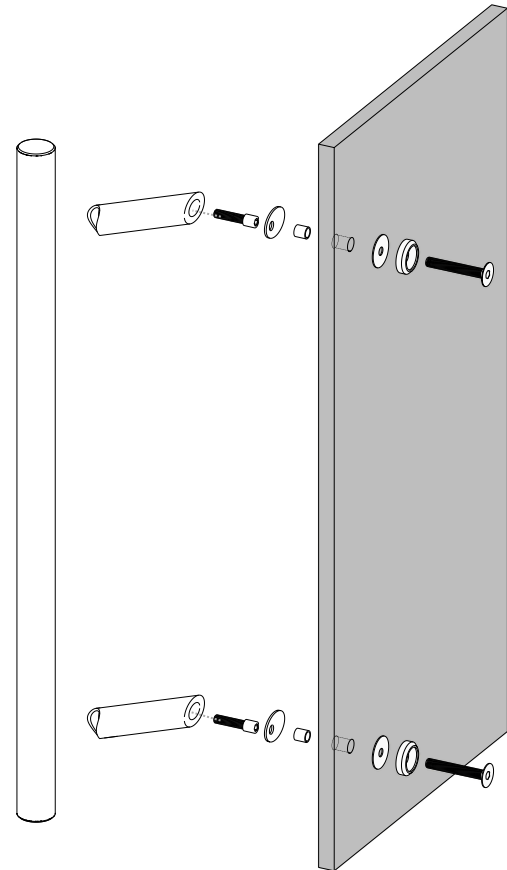

Axonometric View

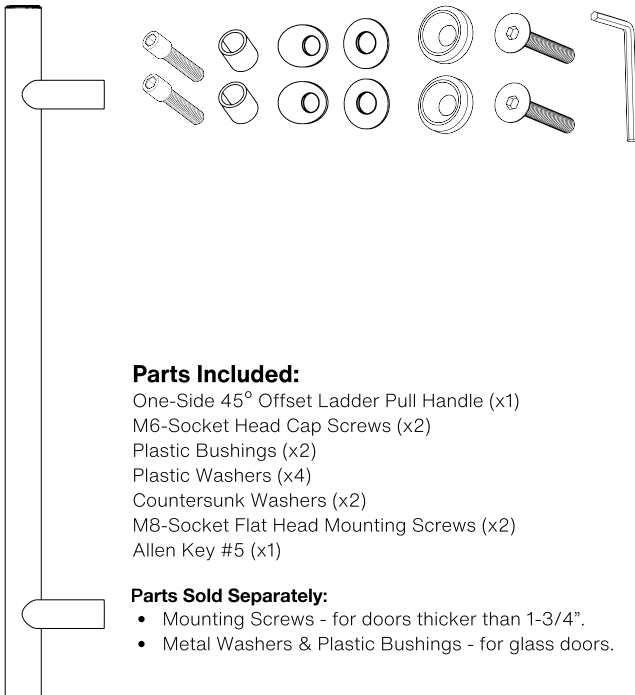

## Parts Included:

- One-Side 45° Offset Ladder Pull Handle (x1)
- M6-Socket Head Cap Screws (x2)
- Plastic Bushings (x2)
- Plastic Washers (x4)
- Countersunk Washers (x2)
- M8-Socket Flat Head Mounting Screws (x2)
- Allen Key #5 (x1)

## Parts Sold Separately:

- Mounting Screws - for doors thicker than 1-3/4".
- Metal Washers & Plastic Bushings - for glass doors.



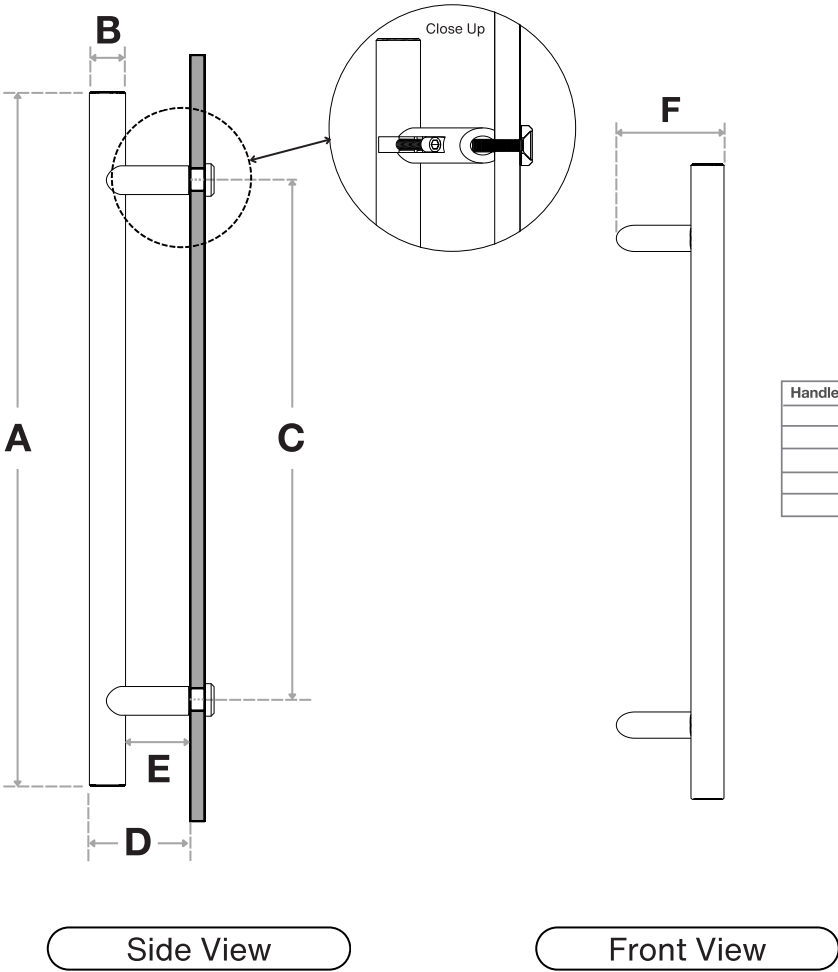

Handle Length (A)	Diameter (B)	Center-to-Center (C)	Projection (D)	Clearance (E)	Width (F)
18"	1-1/4"	12"	5-3/16"	3-1/8"	3-1/4"
24"	1-1/4"	18"	5-3/16"	3-1/8"	3-1/4"
36"	1-1/4"	30"	5-3/16"	3-1/8"	3-1/4"
48"	1-1/4"	42"	5-3/16"	3-1/8"	3-1/4"
60"	1-1/4"	54"	5-3/16"	3-1/8"	3-1/4"

FINISHES (1)

- Clear Anodized Aluminum = C
- Black Anodized Aluminum = B

OVERALL LENGTHS (2)

- 18" = 18
- 24" = 24
- 36" = 36
- 48" = 48
- 60" = 60

DIAMETERS (3)

1-1/4" = 1250

For a complete SKU# add Finish (1), Overall length (2) and Diameter (3)

SH-PRO-ALU-OLP-CW- - -

FINISH OVERALL LENGTH DIAMETER

Material: Aluminum.

DOOR TYPE	GLASS DOORS UP TO 3/4"	WOOD & METAL DOORS. UP TO 4-3/4"
HOLE SIZE DIAMETER	5/8"	5/16"

Not all Finishes, Lengths and Diameters are available in this style.  
For customization requests, please contact us at [info@strongarhardware.com](mailto:info@strongarhardware.com)