

Pro-Line Collar Mounted Series™

84 inch PostMount Offset Pull Handle
with 3-hole mounting

Back to Back
Suitable for Glass, Wood and Metal Doors

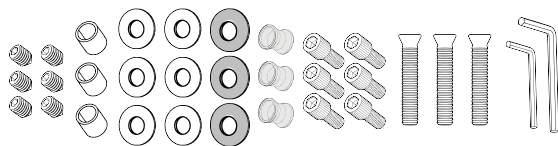
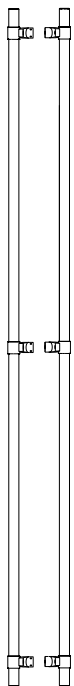
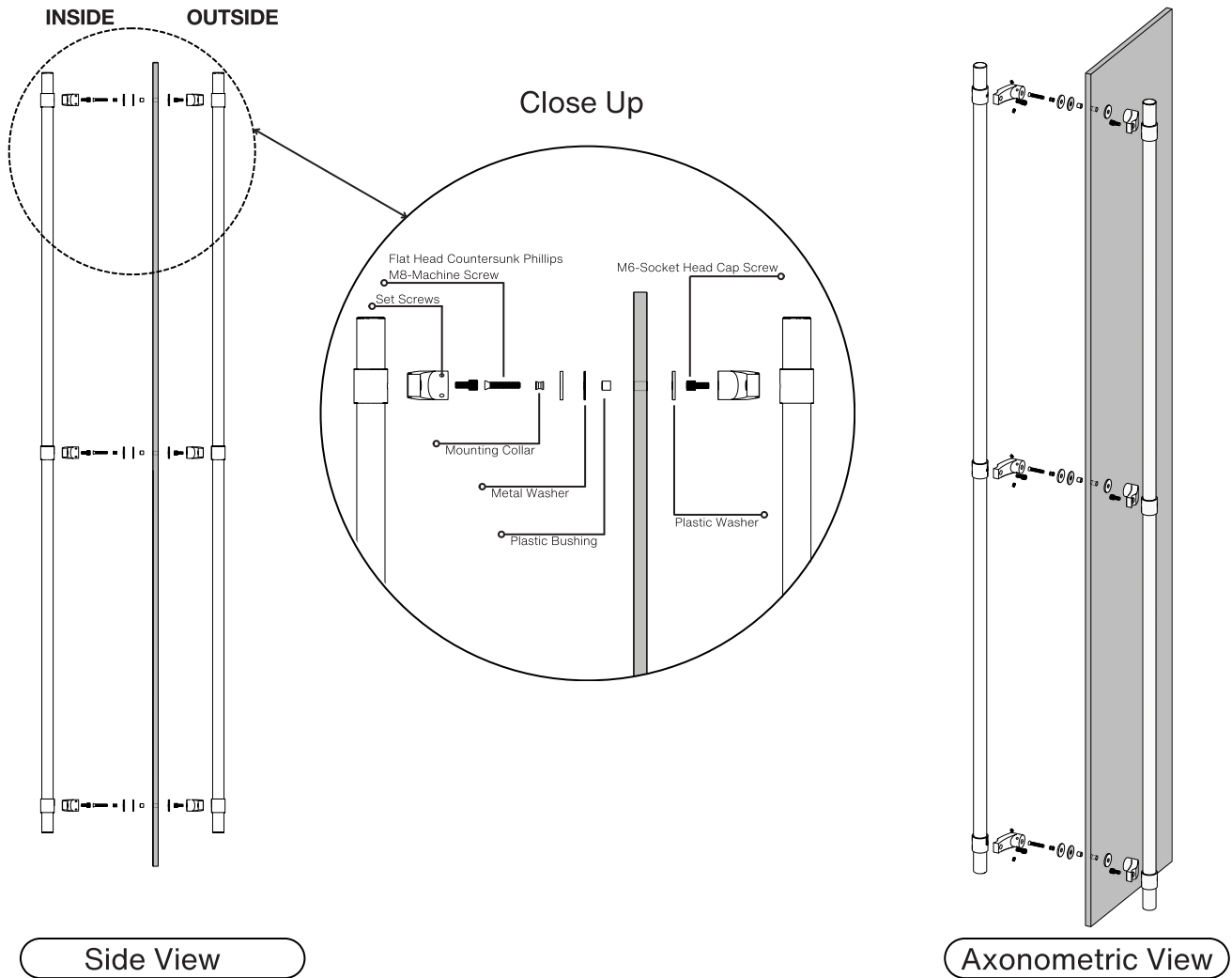

Parts Included:

- PostMount offset Pull Handle (x2)
- 10mm Set Screws (x6)
- Plastic Bushings (x3)
- Plastic Washers (x6)
- Metal Washers (x3)
- Mounting Collar (x3)
- M6-Socket Head Cap Screw (x6)
- Flat Head Countersunk Phillips M8-Machine Screw (x3)
- Allen Key #3 (x1)
- Allen Key #5 (x1)

Parts Sold Separately:

- Mounting Screws - for doors thicker than 1-3/4".
- Metal Washers & Plastic Bushings - for Glass Doors.



Pro-Line Collar Mounted Series™

84 inch PostMount Offset Pull Handle
with 3-hole mounting
Back to Back
Suitable for Glass, Wood and Metal Doors

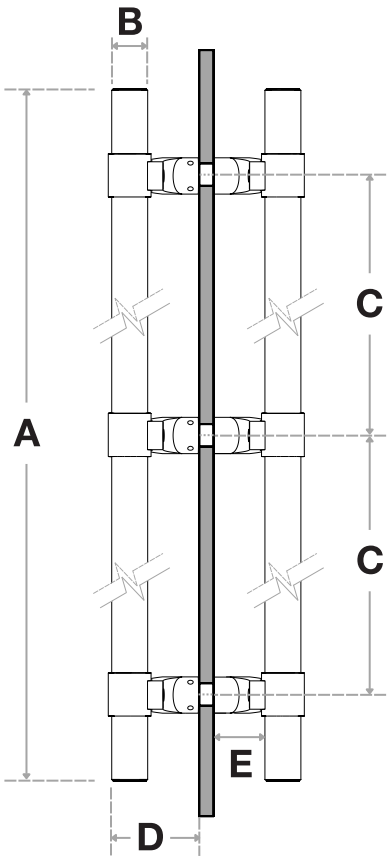

Side View

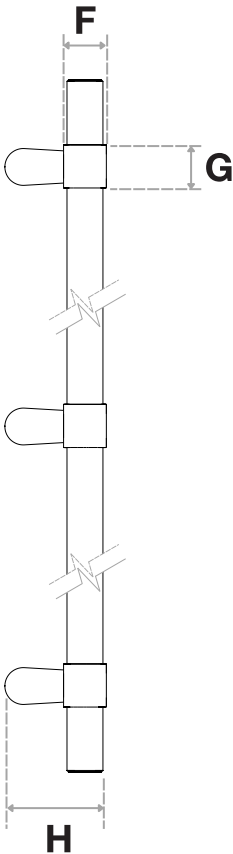

Front View

Handle Length (A)	Diameter (B)	Center-to-Center (C)	Projection (D)	Clearance (E)
84"	1-1/4"	39" + 39"	2-7/8"	1-5/8"

Collar Diameter (F)	Collar Height (G)	Wide (H)
1-1/2"	1-1/2"	3-1/4"

FINISHES (1):

- Brushed Satin = S
- Polished = P
- Matte Black Powder Coated = B
- Satin Brass = SB

OVERALL LENGTH (2)

84" = 84

DIAMETER (3)

1-1/4" = 1250

For a complete SKU# add Finish (1), Overall length (2) and Diameter (3)

SH-PRO-316-OLPN-CMP-3P- - -
FINISH OVERALL LENGTH DIAMETER

Material: 316 grade stainless steel alloy.

DOOR TYPE

GLASS DOORS
UP TO 3/4"

WOOD & METAL DOORS.
UP TO 4-3/4"

HOLE SIZE
DIAMETER

5/8"

5/16"

Not all Finishes, Lengths and Diameters are available in this style.
For customization requests, please contact us at info@strongarhardware.com